

KEY

- ETC S4 SODEG @575w
- ETC S4 JR @575w
- ADJ 7PZ IP @105w
- ADJ 64B LED PRO @30w
- CHALVET COLOR DASH ACCENT QUAD @10w
- ADJ PINPOINT GO COLOR @5w
- PRACTICAL
- ADJ 32 HEX PANEL IP
- ELATION ANTARI DARK FX WASH 2000IP

LEGEND

- TEMPLATE
- INSTRUMENT #
- IF1 - FIXTURE TYPE
- CHANNEL #

DRAWING SCHEDULE		
VER.	DATE	DESCRIPTION
1	04/16/2019	SHOP PREP

THIS DRAWING REPRESENTS VISUAL CONCEPTS AND CONSTRUCTION SUGGESTIONS ONLY. IT DOES NOT REPLACE THE KNOWLEDGE AND ADVICE OF A LICENSED STRUCTURAL ENGINEER. THE DESIGNER IS UNQUALIFIED TO DETERMINE THE STRUCTURAL OR ELECTRICAL APPROPRIATENESS OF THIS DESIGN, AND WILL NOT ASSUME RESPONSIBILITY FOR PROPER ENGINEERING, CONSTRUCTION, HANDLING, OR USE.

ALL MATERIALS AND CONSTRUCTION MUST COMPLY WITH THE MOST STRINGENT APPLICABLE FEDERAL AND LOCAL FIRE, SAFETY, ENERGY, AND ENVIRONMENTAL CODES.

PRODUCED BY: Theme Park

MAZE DESIGNER Joe Bitroll
 LIGHTING LEAD Hannah Beerfas
 PRODUCTION ELECTRICIAN Maggie Corn

CORN MAZE

General Notes

- All Scarecrow pinspots (ch.20,21/LF2) and Outhouse Row pinspots (ch.11/LF3) to be installed at base of object. To be hidden under hay or something along with the theme of the maze. LED for fire protection.
- All hay string lights (ch.7,8/LH1) to be draped along top of hay so that they are visible on the side as well. LED for fire protection.
- All lightposts (ch.22,23/LF1,LF4) to be placed outside maze walls, with the stem arching over the corn walls into the maze to provide dim, flickering light.
- All Outhouse Row strobes (ch.12/LW4) and Barn Finale Strobe (ch.17/LW5) to be placed in wall so the instrument is hidden from maze-goers.
- All lighting fixtures scaled 3x larger to help be seen on plot.

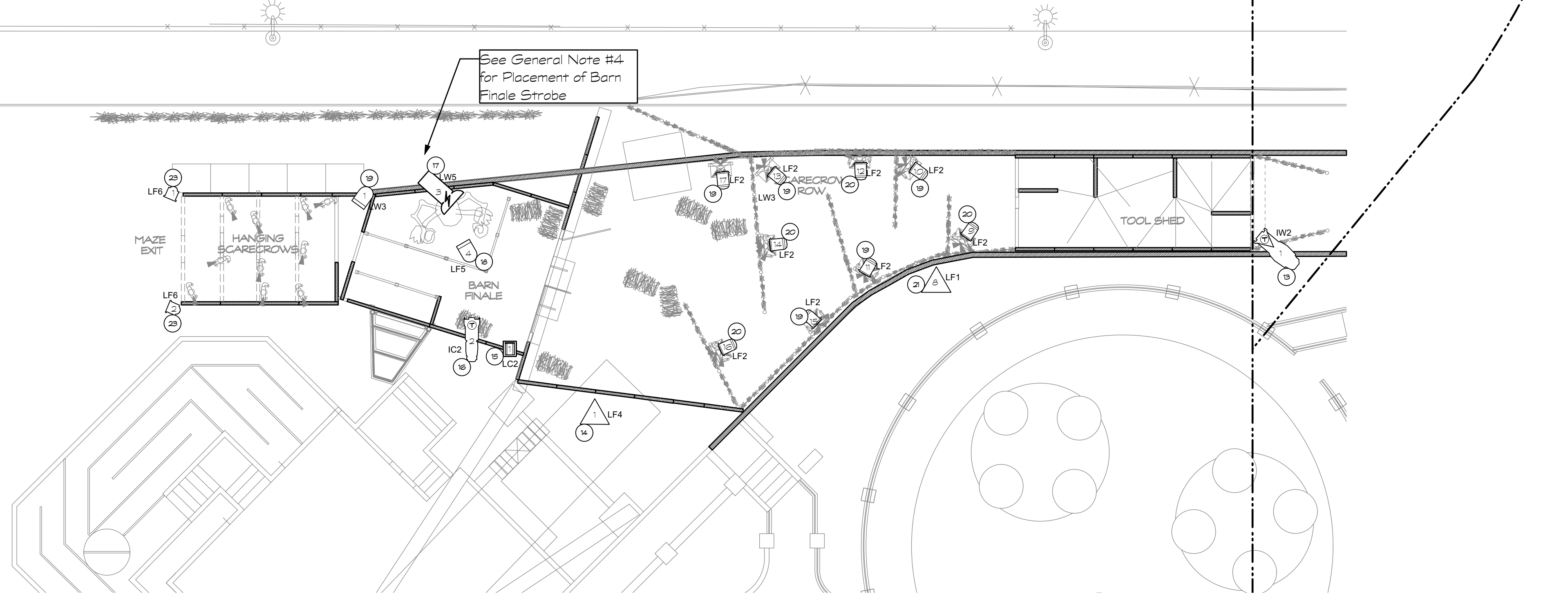

LIGHTPLOT

SCALE: 1/8" = 1'-0" EXCEPT WHERE NOTED

DATE: 04/16/2019

DRAWN: HB

1
of 1